

INSTALLATION INSTRUCTIONS

HONEYCOMB & HYBRID PLEAT SHADES

AUTOMATE™ MOTORIZATION

Thank you for your purchase. This shade has been custom built for you from the highest quality materials. To avoid errors and save valuable time, please read these instructions before installing your new shade.

TOOLS YOU WILL NEED

1. Pencil or Marker
2. Measuring Tape
3. Phillips Screwdriver
4. Carpenter's Level
5. Power Drill
6. Mounting Fasteners

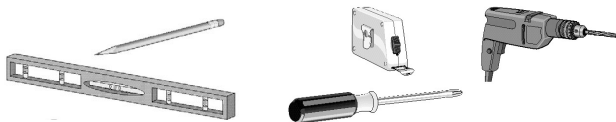

Mounting Surface	Fastener
Drywall, Plaster	Wall Anchors, Expansion Bolts (Not Provided)
Metal	Sheet Metal Screws (Not Provided)
Wood	No. 6 Hex Head Screws (Provided)

GETTING STARTED

All the required installation components are wrapped in your package along with these instructions. Check that the parts you have correspond to the parts shown below. **NOTE:** Some parts may vary depending upon your mounting option.

PARTS

- Installation Brackets
- Spacer Blocks (optional)
- Extension Bracket (optional)
- Hold Down Brackets (optional)
- Screws
- Extension wire – motor to External Battery Pack (optional)..... Not Shown
- Extension wire – Battery (internal or external) to Charger (optional)... Not Shown
- External Battery Pack (optional)
- Charger (optional)
- Solar Panel (optional)
- Remote (optional)

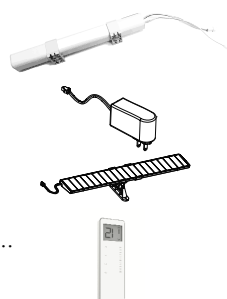
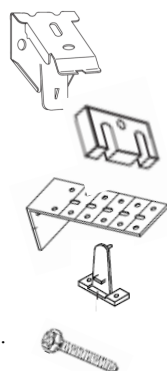

MOUNTING THE BRACKETS

The installation brackets may be used for **INSIDE** or **OUTSIDE** mounts.

Mounting the brackets level is essential for proper operation of the shade. Shim the brackets if necessary to achieve a level alignment.

The bracket requirements and placements are the same for inside and outside mounts. Refer to the following spacing diagram and bracket requirement chart.

Installation Bracket Requirement Chart

Shade Width	Brackets Required
up to 38"	2
38-1/8" to 72"	3
Over 72-1/8"	4

INSIDE MOUNTS:

For inside mounts the installation brackets will be screwed in place through the top two holes of each bracket. Refer to the mounting depth chart below.

	Minimum Depth	Fully Recessed
Internal Battery	3/4"	2-1/4"
External Battery	2-5/8"	3-1/4"

Note: Prior to mounting the brackets, add any clearance depth required to avoid obstructions such as window cranks or handles.

ATTACH THE BRACKETS:

- Screw installation brackets through top two holes to desired window sill location.
- Ensure all brackets are level and aligned.

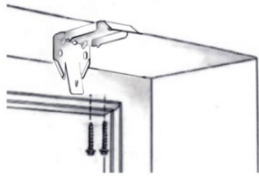

OUTSIDE MOUNTS:

INTERNAL BATTERY

For outside mounts the standard installation brackets will be screwed in place through the two back holes of each bracket. Refer to the minimum surface height chart below.

Minimum Height
1-1/2"

ATTACH THE BRACKETS:

- Screw standard brackets through two back holes to desired location.
- Ensure all brackets are level and aligned.

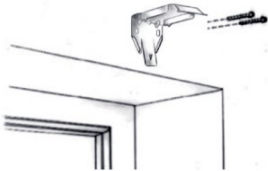

EXTERNAL BATTERY (attached to the headrail)

EXTENSION BRACKETS (**required** if external battery pack is mounted on the back of the headrail):

- Position the extension brackets to the desired wall location.
- The bracket tops must be aligned and level to one another.
- Mount the extension brackets through the back holes with two screws.
- Attach installation brackets to extension brackets with included screws & nuts.



Note: Use the same holes for all brackets to ensure even projection from the surface.

SHADE INSTALLATION

The receiver wire is a small white wire that comes out of the motor. Before mounting the headrail, make sure that the receiver wire is out of the headrail. For optimal performance, position the receiver wire so it extends into the room.

Internal Battery

The charging port is mounted to a base on the back of the headrail. Avoid placing the bracket over the charging port.

External Battery

The external battery must be attached to the motor prior to use. The motor to battery cord has a smaller two pronged attachment. Find the corresponding attachment running out one end of the battery. The cord from the battery with the larger square snap-in attachment connects to the recharging cord or battery to recharging cord extension wire. The battery can either be attached to the back of the headrail using the wire clips connected to the mounting brackets or attached to the window frame in a discreet location.

MOUNT THE HEADRAIL:

- With the front side of the shade facing you...
- Tilt the headrail slightly backward to angle the front inside lip to the brackets. (A)
- Push the headrail back and upward to snap in it into place (B).

Make sure that no fabric is pinched between the brackets and the headrail.

Be sure the motor wire and charging port do not interfere with the bracket.

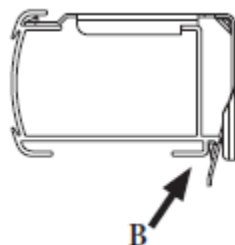
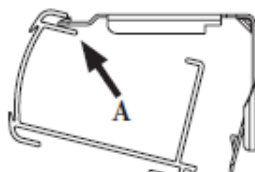

REMOVING THE SHADE

To remove a shade, insert a screwdriver between the headrail and the bottom back of the bracket (tab which extends out slightly from each bracket).

Gently pry the screwdriver to release the bracket from the headrail. Take care not to damage the painted finish of the headrail.

As you release the brackets, support the headrail to keep it from falling.

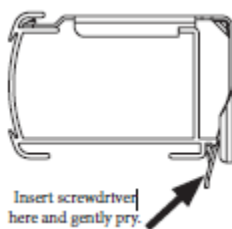

INITIAL SET-UP

Pair motor with controller:

Select channel on controller.
(Disregard if using single channel controller)

Hold **P1** button on motor head

Hold **STOP** on controller



IMPORTANT

Consult user manual for your controller for information on selecting channel.

Motor Response

Motor Response



and ready for setting limits.

Check motor direction:

To check travel direction of shade, press **UP** or **DOWN** on controller.

To reverse shade direction, hold both **UP** and **DOWN** until motor responds

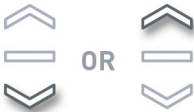

otor

Set limits:



IMPORTANT

Damage to shade may occur when operating motor prior to setting limits. Attention should be given.

To save upper limit, hold **UP** and **STOP**.

Move shade to the desired highest or lowest position by pressing the **UP** or **DOWN** buttons on controller.



se

Approx.



JOG
x2



Initial set-up is now complete

ADJUSTING LIMITS

Adjust upper limit:

Hold **UP** and **STOP** on Controller until the motor responds.

Move shade to the desired upper position by pressing the **UP** or **DOWN** button.

To save upper limit, hold **UP** and **STOP** until the motor responds.



Motor Response

Approx.  

Adjust lower limit:

Hold **DOWN** and **STOP** on controller.

Move shade to the desired lowest position by pressing the **UP** or **DOWN** button

To save lower limit, hold **DOWN** and **STOP**



ADDING OR REMOVING CONTROLLERS AND CHANNELS

Using motor P1 button:

Hold **P1** button on motor head.

Hold **STOP** on controller to add or remove



Using a pre-existing controller:

g controller or channel (to keep)

B= Controller or channel or add or remove

Press **P2** on existing controller.

Press **P2** on existing controller.

Press **P2** on new controller.



FAVORITE POSITIONING

Set a favorite position:

Move shade to the desired position by pressing the **UP** or **DOWN** button on the controller.



ponse



Motor Response



Motor Response



Send shade to favorite position:

Hold **STOP** on controller.



Delete favorite position:

Press **P2** on controller.



Motor Response



Press **STOP** on controller.



Motor Response

Press **STOP** on controller.



Motor Response

ADJUSTING MOTOR SPEED

Increase or decrease motor speed:

To increase speed.



To decrease speed.

ed.

HOLD-DOWN BRACKETS (OPTIONAL)

- Lower the shade and place the hold down pins into the bottomrail end caps.
- Mark the hold down bracket locations on the mounting surface.
- With the brackets level, attach them using two screws.

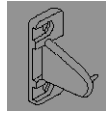

ADJUSTING THE SHADE

- Raise and lower the shade several times.
- If the length is incorrect or the bottomrail is not level, use the following steps to correct.

BOTTOMRAIL SHADE ADJUSTMENT:

- Lift bottomrail on the side to be adjusted. This will take the weight off the cord.
- Use a screwdriver or dime.
 - Turn screw clockwise to lift that side of the shade
 - Turn screw counter clockwise to lower that side of the shade
 - Half a revolution is $\frac{1}{4}$ " adjustment (maximum adjustment is $\frac{1}{2}$ ")

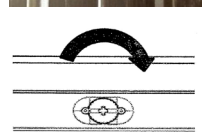
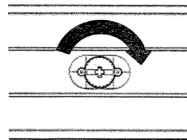

TROUBLESHOOTING

Problem	Cause	Remedy
Motor is not responding	Battery in motor is depleted	Recharge with compatible AC adaptor and check connection and positioning of PV panel.
	Insufficient charging from Solar (PV) Panel	Check connection and orientation of PV panel.
	Transmitter battery is discharged	Replace battery
	Battery is inserted incorrectly into transmitter	Check battery polarity
	Radio interference/shielding	Ensure transmitter is positioned away from metal objects and the aerial on motor or receiver is kept straight and away from metal
	Receiver distance is too far from transmitter	Move transmitter to a closer position
	Power failure	Check power supply to motor is connected and active
	Incorrect wiring	Check that wiring is connected correctly (refer to motor installation instructions)
Motor beeps 10 times when in use	Battery voltage is low / PV (solar) panel issue	Recharge with AC adaptor or check connection and positioning of PV pane
Cannot program a single Motor (multiple motors respond)	Multiple motors are paired to the same channel.	Always reserve an individual channel for programming functions
		SYSTEM BEST PRACTICE - Provide an extra 15 channel remote in your multi motor projects, that provides individual control for each motor for programming purposes
		Place all other motors into sleep mode (ref to P1 function overview)

CLEANING INSTRUCTIONS

Honeycomb shades are made of an anti-static, dust resistant fabric which repels dirt and dust. For most of these fabrics, the following options are available if your shade needs cleaning.

DUSTING: Regular light dusting with a feather duster is all the cleaning that is needed in most circumstances.

VACUUMING: Use a hand-held vacuum with low suction for more thorough dust removal.

SPOT CLEANING: Use the following steps for spot cleaning: (1) Prepare a solution of warm water and mild dishwashing detergent. (2) Dampen a clean cloth in the solution and ring it out. (3) Dab the spot with the dampened cloth until it is gone. **DO NOT RUB THE FABRIC.** (4) Allow the shade to dry in the completely lowered position.

CAUTION: Avoid creasing Blackout fabrics during cleaning.

DEEP CLEANING: Use the following steps for deep cleaning: (1) Immerse shade in basin or bathtub filled with warm water and mild detergent. (2) Rinse with clean water. (3) Fully raise shade and tilt to eliminate excess water, (4) Reinstall damp shade, lower it, and let it dry completely.

CAUTION: Do not immerse Blackout fabrics. Do not immerse the headrail or any fabric-wrapped rail.

ULTRASONIC CLEANING: Standard shades, except those made with Blackout Lining can be ultrasonically cleaned by a professional.

- Specify that a mild detergent be used.
- Never immerse the headrail or any fabric-wrapped rail in the solution.
- Dry the shade completely in the lowered position.

CAUTION: Do not ultrasonically clean Blackout fabrics. Do not immerse headrail.

WARRANTY INFORMATION

Lifetime Limited Warranty covering our Custom Made Shades

We extend this lifetime limited warranty to the original purchaser. This warranty applies only to manually operated Custom Products properly installed in the window, door or interior area for which they were intended. Installation of the product must be in accordance with accompanying instructions. The product cannot be modified. It is the purchaser's responsibility to maintain and clean the product in compliance with the instruction provided. The product must be used only in the window for which it was purchased. Damage to the product resulting from misuse, abuse, direct exposure to salty air or discoloration due to sunlight or the passage of time is not covered by this warranty.

This warranty does not apply to conditions caused by normal wear and tear upon the product. This warranty is exclusive and in lieu of all other obligations, liabilities or warranties. In no event shall the Manufacturer be liable for incidental or consequential damages or for any other direct or indirect damage, loss, cost, expense or fee. Some states do not allow the exclusion or limitation of incidental or consequential damages, so this exclusion or limitation may not apply to you.

In the event of a defect under this warranty, we will repair or replace the product, at our option, provided it is returned to our store. Our warranty obligation excludes shipping charges and labor costs for measuring and installation. Repairs will be made with like or similar parts. This warranty gives you specific legal rights, and you may have other rights which vary from state to state.

Notes: Motorization Systems are warranted for five years from the date of purchase. Specialty Blinds and Shades are warranted for one year from the date of purchase.

This warranty does not apply to Commercial Orders.

